



# SURETRAC

## BETTER VISIBILITY WITH ESD

The MICRO-TECH Traction Device 'SureTrac' offers a practical and proven method for supporting ESD procedures in the gastrointestinal tract. With the LOCKADO™ Premium Clip and the elastic silicone band, the preloaded system enables efficient tissue tension and improves the view of the resection area. The traction is achieved by hooking

a second clip into one of the four available rings. The four rings allow individual adjustment of the span and can be readjusted during the procedure. SureTrac is a functional system that enables easy handling and effectively supports the clinical workflow.

## SPECIFIC CHARACTERISTICS

- Preloaded traction system
- Elastic, latex-free silicone tape
- Small retaining ring secures silicone band to the clip arm
- Improved view of the resection area

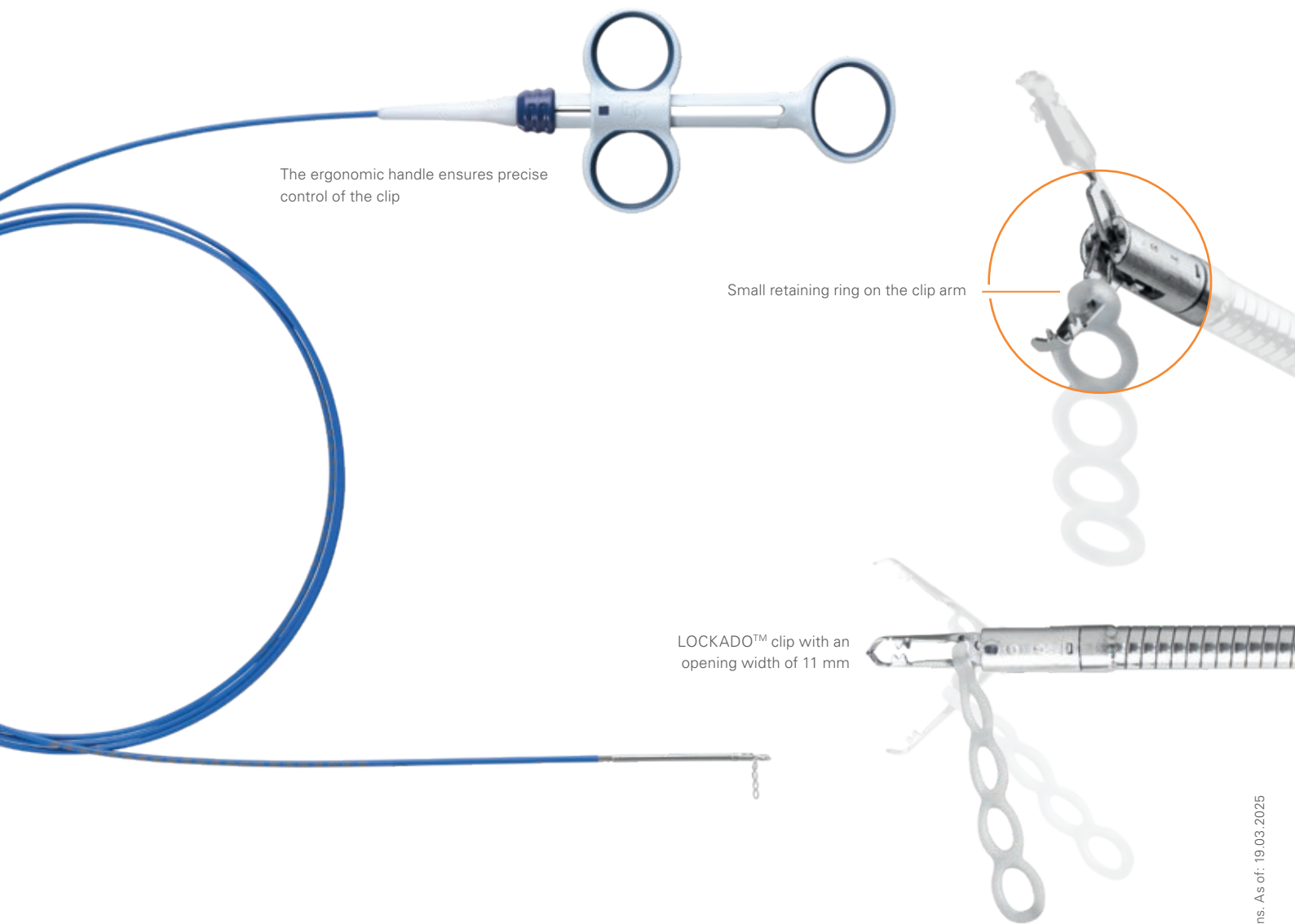

## SPECIFICATIONS

REF	Clip max. opening width mm	Total length mm	Working channel Ø mm	Inner diameter mm between the first and fourth ring
<b>SURETRAC</b>				
ETD01008	11	2350	3.2	12.3

Packaging unit: 10 pieces

Subject to errors and technical modifications. As of: 19.03.2025